

### Main Transportation Issues

- Am Durotolu (Tolu) Aro
  - Live in Royal Oak.
  - New Transportation Director.
  - First meeting
- Main Issue Outlined to me are
  - Country Hill/112st Street intersection
  - Parking near the LRT
  - Traffic at the elementary school

### Traffic at the elementary school

- Put up more no “U” turn signs along Royal Birkdale Dr.
- Can another entry be made as indicated by the blue arrow?



### New Middle school drop off

- Second outlet for parking lot.
- Can the Skating ring parking lot be linked to the middle school lot?

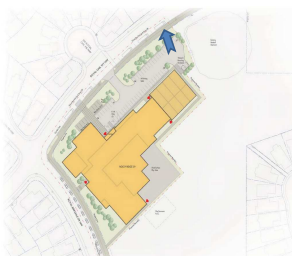

### Questions

- Left turn traffic sign was to be raised.....what happened?
- Can the timer for the left turn light (from 112<sup>th</sup>) be adjusted to have a longer on time during busy hours?

### Country Hills @ 112<sup>th</sup>/Royal Birch

- What happened to the no “U” turn sign.

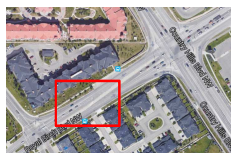

### Royal Oak Drive

- There is no ramp where the cycling path crosses the road.

